

Datasheet KMG 103

EAE KNX-Modbus TCP Router

KNX PSU & Energy saver without card holder (KMG103 R0)

All you need is EAE



Datasheet KMG 103

EAE KNX-Modbus TCP Router

KNX PSU & Energy saver without card holder (KMG103 R0)

General Features



- EAE KMG103 can be used to control and monitor KNX installations via SCADA visualization software.
- IP address of device can be given by DHCP server or by manual configuration.
- EAE KMG103 includes patent-pending logic controller that enables room energy saver system without using card holder.
- Device has 3 physical inputs for door, window and presence sensing.
- EAE KMG103 has built-in 320mA or 640 mA KNX bus power supply for KNX devices.
- KNX Power supply output is short-circuit and overload protected.
- Power, overload and reset statuses are indicated with three different LED indicators.
- Power supply can be restarted by pressing reset button on the device.

Technical Data

Type of Protection	IP20	EN 60 529
Safety Class	II	EN 61 140
Insulation Category	Over voltage category Pollution Degree	III EN 60 664 - 1 2 EN 60 664 - 1
Main Supply	Input Voltage Power consumption	150-275V AC, 50-60Hz 7W
Output	KNX Bus	30 VDC +1 / -2V, SELV (Integrated choke) 640mA
Connection	IP Line KNX Line	RJ45 socket for 10/100BaseT, IEEE 802.3 networks Bus Connection Terminal
Display Elements	ETH Link ETH Act LED for programming mode	Satatus Fault
Operating Elements	Function button, Programming button	
Installation	35mm DIN rail mount	EN 60 715 TH 35-75
Temperature Range	Operation Storage	-5°C + 45°C non-condensing -20°C + 60°C
Humidity	5% to 93% no maisture condensation	
Dimensions	H x W x D	90mm x W x 70mm
Weight	66g	
Box	Plastic PA66 housing gry	
CE	in accordance with EMC and low voltage guidelines Device complies with, EN 50090-2-2, IEC 60664-1	

Functional Elements and Connections

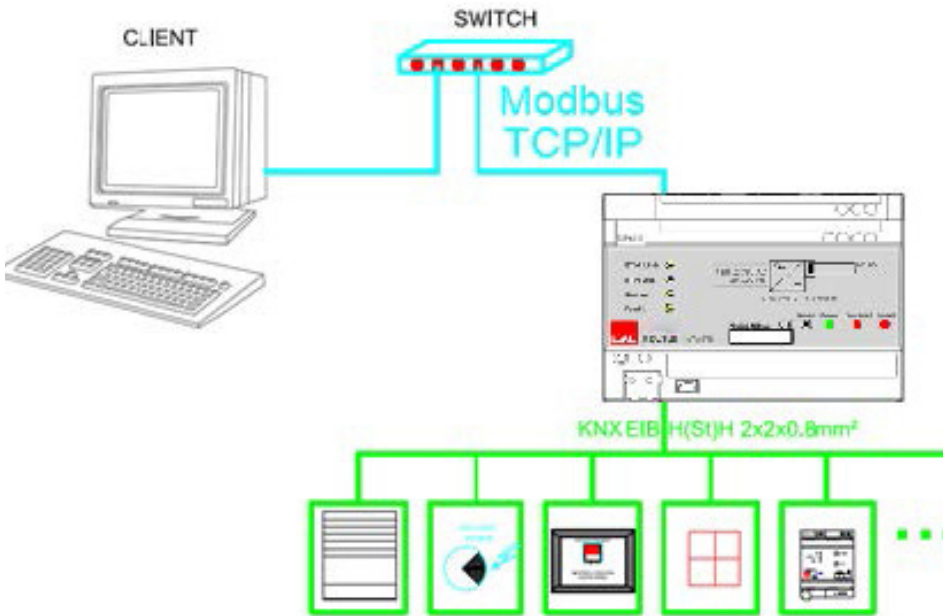

Scale Drawing

